



**GT2100 Full Open no Track Manual Slide Door
Installation Manual**
P/N C-00100 Rev 7-24-18

Nabco Entrances Inc. S82 W18717 Gemini Drive Muskego, Wisconsin 53150
Phone: (877) 622-2694 Fax: (888) 679-3319 www.nabcoentrances.com
NABCO hours of Operation: Monday to Friday 8:00 a.m.- 4:30 p.m. (Central Time)

*Associated Manuals Part Numbers: Manual Slide Door Owner's Manual (P/N C-00189) for Decal Installation
NABCO Price Book" for Sensors, Switches, and Accessories (P/N 16-9244-30)*

Table of Contents

CHAPTER 1: WARNING LABELS 3

CHAPTER 2: GENERAL SAFETY RECOMMENDATIONS 3

CHAPTER 3: SCOPE 3

SECTION 3.1: To the Installer 3

SECTION 3.2: Objective 4

CHAPTER 4: GETTING STARTED 4

SECTION 4.1: Type of Unit. 4

SECTION 4.2: Inspect the Rough Opening 4

CHAPTER 5: ASSEMBLE DOOR FRAME 5

CHAPTER 6: INSTALL THE DOOR FRAME 5

SECTION 6.1: Prepare Door Frame. 5

SECTION 6.2: Secure Door Frame to Building 6

CHAPTER 7: INSTALL THE FULL OPEN SIDELITE 6

SECTION 7.1: Install the Bottom Pivot 6

SECTION 7.2: Insert Pivot Pins into Pivots 7

SECTION 7.3: Adjust Door Height. 7

SECTION 7.4: Prepare the Header for the Flush Bolt 8

SECTION 7.5: Install the Bottom Guide 8

CHAPTER 8: INSTALL THE SLIDE DOOR 9

SECTION 8.1: Lift Carrier onto Track. 9

CHAPTER 9: INSTALL WEATHERING 10

CHAPTER 10: INSTALL THE GLASS STOPS. 10

CHAPTER 11: GLAZING (HEAVY/WIDE DOORS). 11

CHAPTER 12: ADJUSTMENTS. 11

SECTION 12.1: Adjust Height on Slide Door 11

SECTION 12.2: Adjust the Nose Caster. 12

SECTION 12.3: Correct Preload Misalignment 12

SERVICE PARTS: KIT 14

SERVICE PARTS: HEADER 15

SERVICE PARTS: FULL OPEN SIDELITE 16

SERVICE PARTS: RIGHT HAND FULL OPEN SIDELITE 17

SERVICE PARTS: LEFT HAND FULL OPEN SIDELITE 18

SERVICE PARTS: SLIDE DOOR 20

SERVICE PARTS: RIGHT HAND SLIDE DOOR 21

SERVICE PARTS: LEFT HAND SLIDE DOOR 22

CHAPTER 1: WARNING LABELS

Warning labels are universal and used to alert an individual of potential harm to one's self or to others. The following warning labels are listed in a hierarchy order that defines the most potential danger first, and the least potential danger last. Please refer to this page in the event that a warning label is displayed within this manual and further definition needs to be explained.

DANGER

Indicates potentially dangerous situations. Danger is used when there is a hazardous situation where there is a *high* probability of severe injury or death. It should not be considered for property damage unless personal injury risk is present.

WARNING

Indicates a hazardous situation which has *some* probability of severe injury. It should not be considered for property damage unless personal injury risk is present.

CAUTION

Indicates a hazardous situation which *may result in a minor injury*. Caution should not be used when there is a possibility of serious injury. Caution should not be considered for property damage accidents unless a personal injury risk is present.

Attention: A situation where material could be damaged or the function impaired.

Notice: Indicates a statement of company policy as the message relates to the personal safety or protection of property. Notice should not be used when there is a hazardous situation or personal risk.

Note: Indicates important information that provides further instruction.

CHAPTER 2: GENERAL SAFETY RECOMMENDATIONS

WARNING

Do not install, operate or service this product unless you have read and understand the General Safety Recommendations, Warning Labels, contained in this manual. Failure to do so may result in bodily injury, or property damage.

WARNING

Read, study and understand the installation and operating instructions contained in, or referenced in this manual before operating. If you do not understand the instruction, ask a qualified technician. Failure to do so may result in bodily injury, or property damage and will nullify all warranties.

CAUTION

If the door appears broken or does not seem to work correctly, it should be immediately removed from service until repairs can be carried out or a qualified service technician is contacted for corrective action.

Notice: This manual, the owner's manual and all other associated manuals must be given to and retained by the purchasing facility or end user.

CHAPTER 3: SCOPE

SECTION 3.1: To the Installer

The purpose of this manual is to familiarize the installer and purchaser with the proper installation and operation of this system. It is essential that this equipment be properly installed and operational before the door is used by the public. In the United States, ANSI Standard Z97.1 covers Glass Installation. It is the installer's responsibility to inspect the operation of the entrance system to be sure it complies with any applicable standards.

Instruct the building owners and operator on the essentials of the operation of the door and this device. The owner should follow these instructions to determine whether the door is operating properly and should immediately call for service if there is any malfunction. All installation changes and adjustments must be made by qualified, NABCO trained technicians.

Note: As an Option, the GT-2100 Manual Slide door can be certified to have a Smoke and Air Infiltration NFPA-105 rating for sprinklered buildings (in the United States only).

SECTION 3.2: Objective

The GT-2100 is designed to be installed within a rough opening of a building. The door functions to manually open and manually close with a full breakout feature. This manual offers step by step instructions.

CAUTION

A pedestrian Door that does not have its glass sections installed at the Factory shall specify that the glazing material employed is to comply with the requirement in UL 325 par.29.5.1:

“The glazing material in both fixed and sliding panels of all sliding doors and in all unframed swinging doors shall comply with the requirements in the Performance Specifications and Methods of Test for Safety Glazing Material Used in Buildings, ANSI Z97.1. Glazing material for other pedestrian doors shall also comply with ANSI Z97.1, except that single strength or heavier glass may be used for those portions of doors involving a glazed area of less than 1ft² (0.9 m²) and having no dimension greater than 18 in (457 mm)”.

CHAPTER 4: GETTING STARTED

SECTION 4.1: Type of Unit

- ▶ Mechanical Configuration: Manually open and close, to the right or left.
- ▶ Emergency Egress: Both the Slide door and Sidelite breakout for emergency egress.
- ▶ Maximum Door Weight Limit: 135 pounds

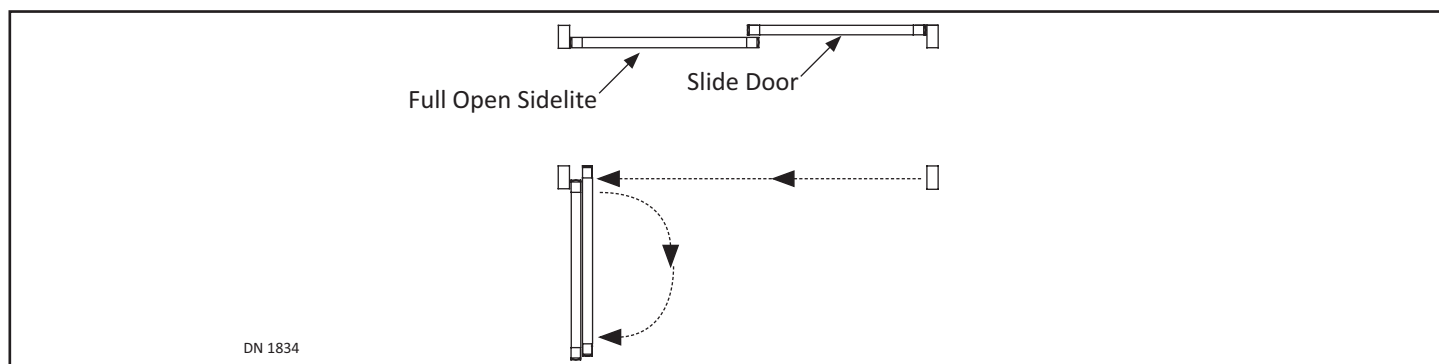

SECTION 4.2: Inspect the Rough Opening

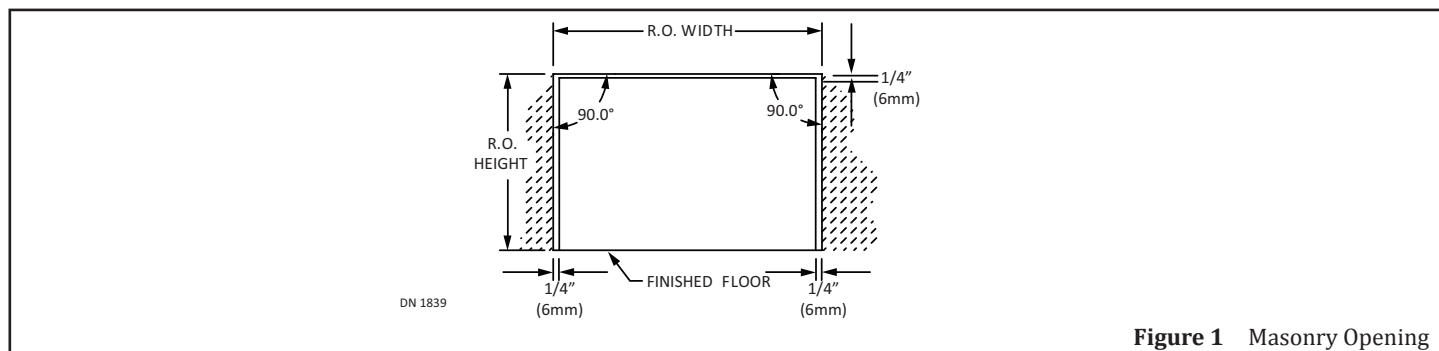

Figure 1 Masonry Opening

1. Ensure the Rough Opening is correct size.
 - ▶ The width of the Rough Opening should equal: **PACKAGE WIDTH + 1/4 INCH ON EACH SIDE**
 - ▶ The height of the Rough Opening should equal: **PACKAGE HEIGHT + 1/4 INCH**

Note: Make allowances for tile or other existing materials that may change the floor height.

CHAPTER 5: ASSEMBLE DOOR FRAME

1. Place the Header on a flat surface with the removable cover facing up. Protect Header from scratches.
2. Position Jamb tubes on either side of Header according to the instruction sticker located on each Jamb Tube that shows proper location and orientation.
3. Position Header so the Removable Cover faces the Non-Breakout side of the opening.

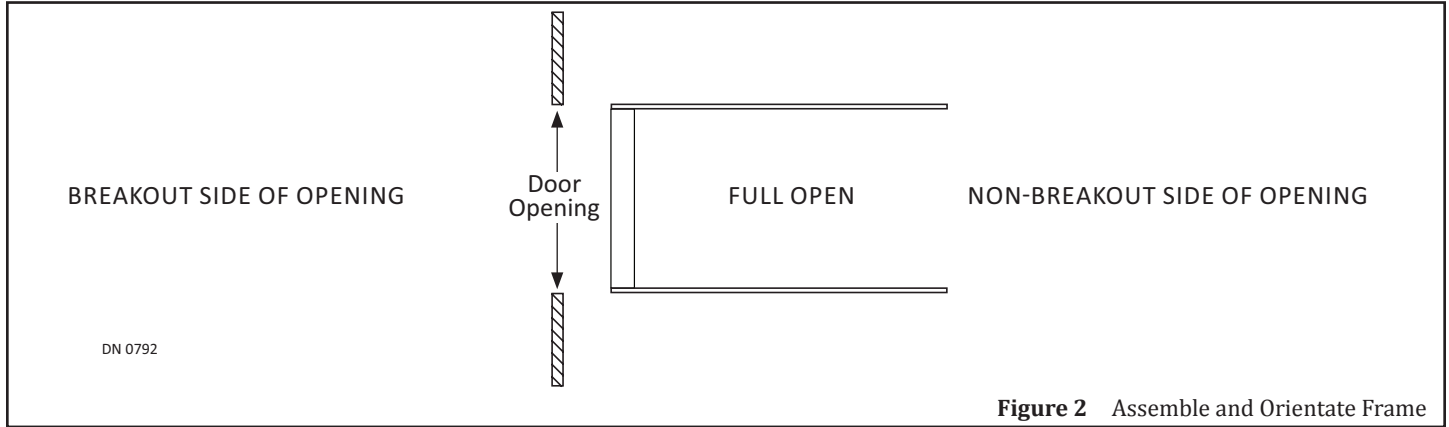

Figure 2 Assemble and Orientate Frame

4. Go to the bottom of Header, remove (2) #8-32 x 5/8" Phillips Head screws used to secure the Removable Cover.
5. Remove the Removable Cover by lifting it up and then pulling it out.

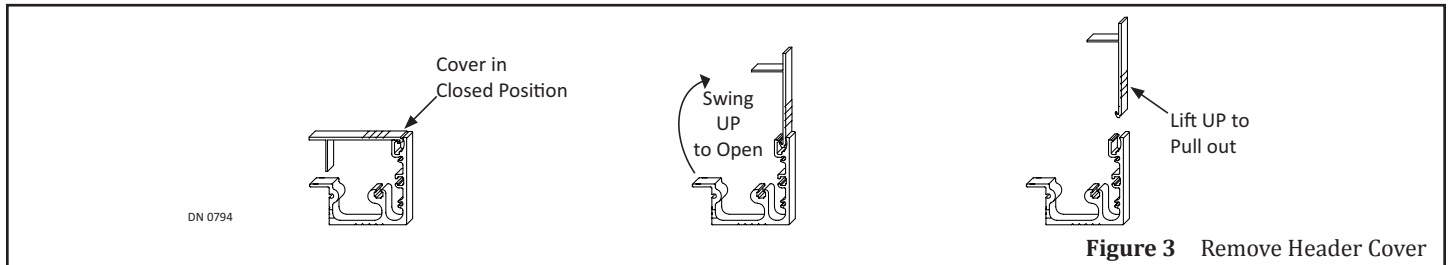

Figure 3 Remove Header Cover

6. Secure Header to Jamb Tubes with (3) 1/4-20 x 3/4 inch Self Tapping Screws.
 - a. Jamb Tubes are Non-Handed and pre-drilled with (4) screw holes.

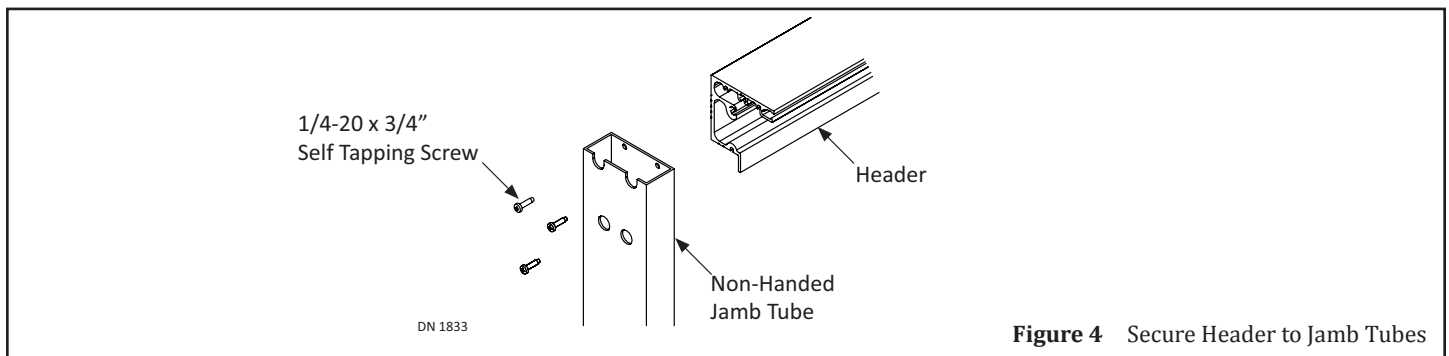

Figure 4 Secure Header to Jamb Tubes

CHAPTER 6: INSTALL THE DOOR FRAME

SECTION 6.1: Prepare Door Frame

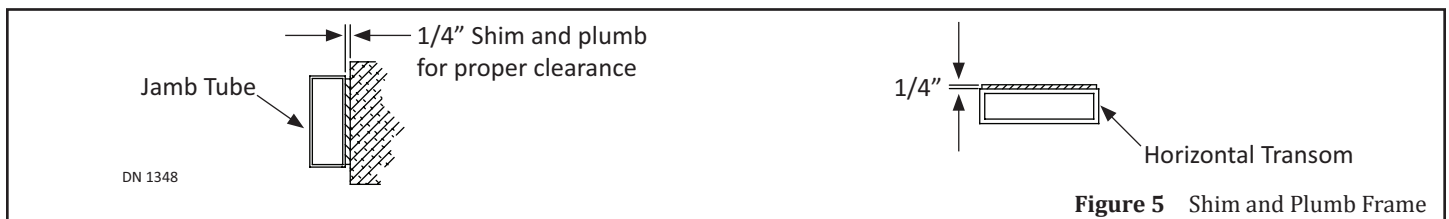

Figure 5 Shim and Plumb Frame

1. Shim and Plumb Jamb Tubes in both planes to ensure the rough opening allows a 1/4 inch clearance.
2. Shim and plumb the Transom Horizontal at the top to ensure the rough opening allows a 1/4 inch clearance.

SECTION 6.2: Secure Door Frame to Building

- ▶ Anchors are not provided by NABCO.
- ▶ Anchors must be appropriate for the type of structure being fastened to.
- ▶ Screw in anchors to secure the Frame (per manufacturer's specifications).
- ▶ Ensure anchor heads do not come in contact with edges of glass to prevent breakage.
- ▶ Do not overtighten anchors to prevent deforming Jamb Tubes.

Note: It is recommended to countersink holes as required to flush the surface.

Note: It is recommended to drill tap threads for 1/4 inch anchors in a steel or aluminum structure.

Note: Do not overtighten anchors to prevent deforming Jamb Tubes.

6.2.1 Anchor Placement for Header

Use 1/4 inch diameter anchors, with a maximum 48 inches on center. First anchor maximum is 36 inches from each end of the Header. Anchors and Fasteners must be appropriate for the type of structure being fastened into. Anchors and Fasteners are not provided by NABCO.

6.2.2 Anchor Placement for Jamb Tube

Use 1/4 inch diameter anchors with a minimum of 3 per Jamb tube, maximum is 48 inches on center. Drill 1/4 inch diameter holes in the face of Jamb and then countersink each hole. Anchors and Fasteners must be appropriate for the type of structure being fastened into. Anchors and Fasteners are not provided by NABCO.

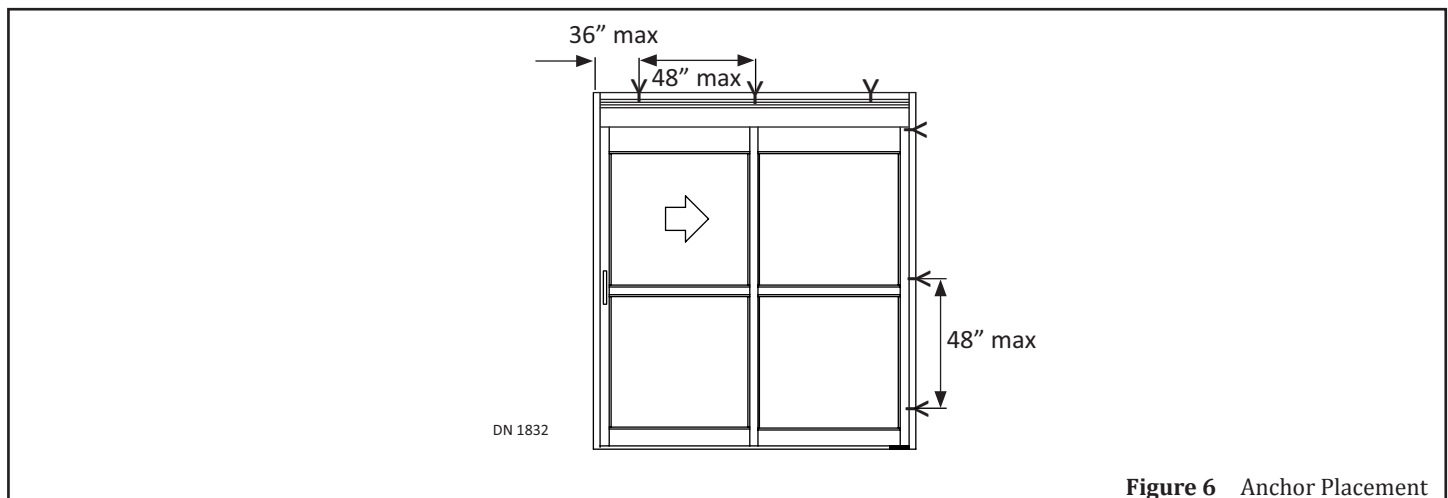

Figure 6 Anchor Placement

CHAPTER 7: INSTALL THE FULL OPEN SIDELITE

SECTION 7.1: Install the Bottom Pivot

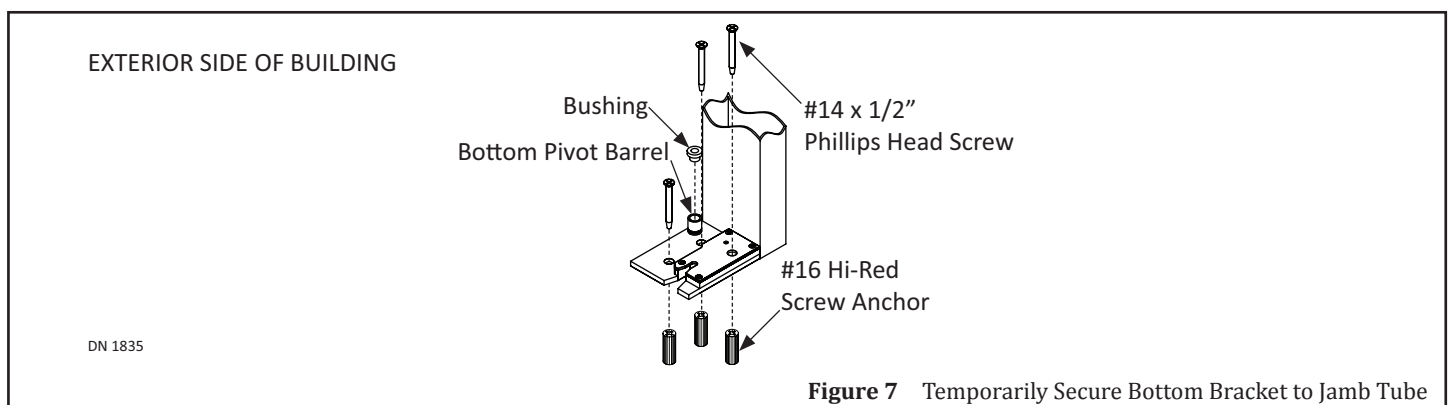

Figure 7 Temporarily Secure Bottom Bracket to Jamb Tube

1. Ensure the Bottom Pivot Barrel is on the Exterior side of Building.
2. Center and butt the Bottom Pivot Assembly up against the Pivot Jamb Tube.
3. Use the Bottom Pivot as a template to mark (3) anchor screw holes.
4. With a Masonry drill bit, drill (3) 1/4 inch screw holes into the floor at least 1-1/2 inches deep.
5. Insert (1) #16 Hi-Red Anchor into each drilled hole.
6. Secure the Bottom Pivot to Floor with (3) #14 x 1-1/2 inch Phillips Head Screws.
7. Cap the Bottom Pivot Barrel with (1) Bushing.

SECTION 7.2: Insert Pivot Pins into Pivots

1. Go to the Pivot Pin located inside the Pivot Stile, at the bottom. Carefully insert the Pivot Pin inside Bottom Pivot Bushing.

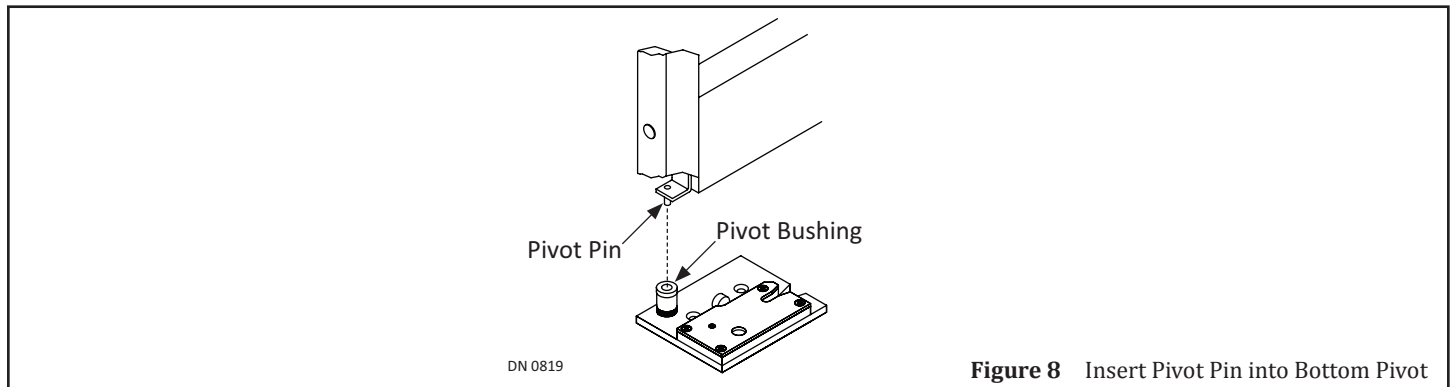

Figure 8 Insert Pivot Pin into Bottom Pivot

2. Locate the Retracting Pivot Pin inside the Top Pivot Stile, and then the Pivot Pin hole at the bottom of Header.
3. Push the Retracting Pivot Pin down into the Pivot Hole, and then let go so the Pin can snap into the Pivot Hole.
 - a. Ensure the Retracting Pivot Pin fully engages the hole.
 - b. If necessary, lift up on the Retracting Pivot Pin with a screwdriver.

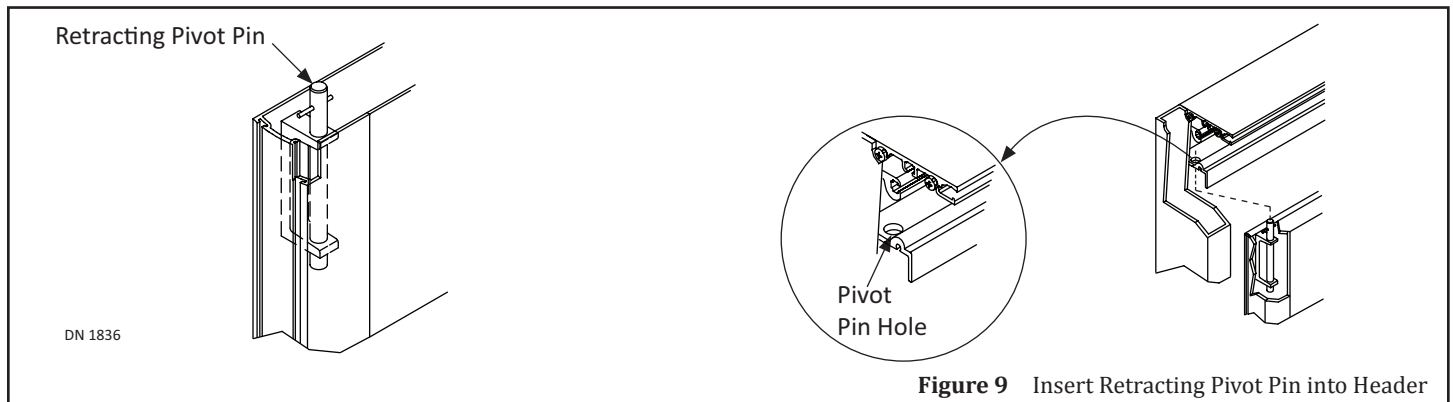

Figure 9 Insert Retracting Pivot Pin into Header

SECTION 7.3: Adjust Door Height

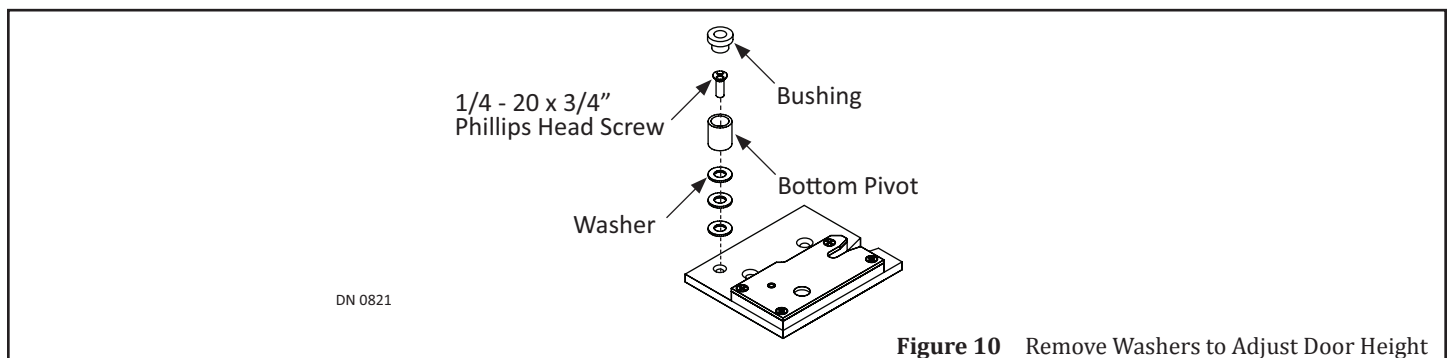

Figure 10 Remove Washers to Adjust Door Height

1. Remove the Sidelite Panel.
2. Go to the Bottom Pivot. Remove (1) Bushing, (1) 1/4-20 x 3/4 inch Philips Head Screw, and the Bottom Pivot Barrel.
3. To adjust the Door Height, add or subtract 1-3 Washers from underneath the Bottom Pivot Barrel.
4. Reinstall hardware and Sidelite Panel.

SECTION 7.4: Prepare the Header for the Flush Bolt

1. Open the Sidelite 10 - 15 degrees.
2. Go to the Strike side of Sidelite Panel. Locate and then raise the Flush Bolt so it extends past the top of door.
3. Close the Sidelite Panel until the Flush Bolt butts up against the face of Header. Locate and mark the center of the Flush Bolt.

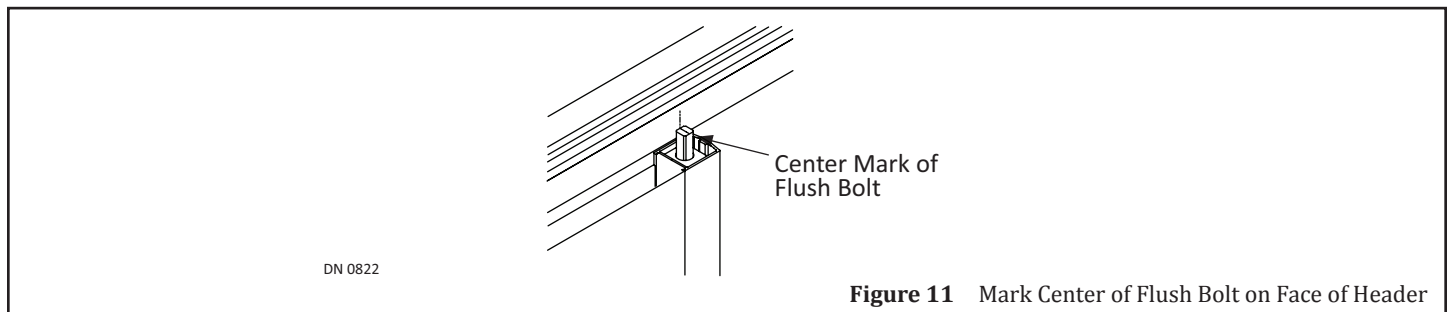

Figure 11 Mark Center of Flush Bolt on Face of Header

4. Open the Sidelite Panel.
5. Extend the marked line down to the bottom, and then under the Header until the second groove, closest to the Face of Header Lip, is reached (Flush Bolt Groove).
6. Drill a 37/64 inch hole into the center of the Flush Bolt Groove.

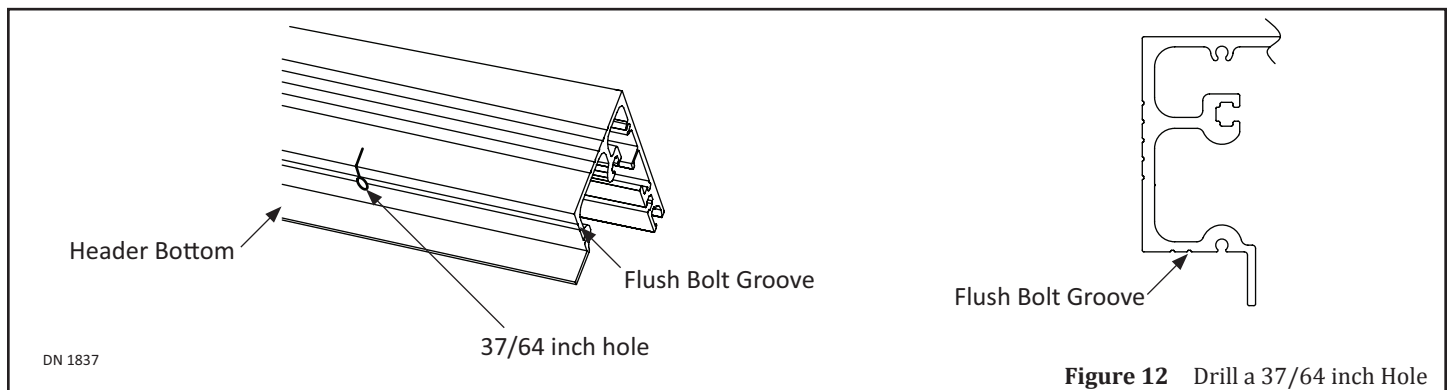

Figure 12 Drill a 37/64 inch Hole

7. Lower the Bolt. Fully close the Sidelite Panel.
8. Raise the Bolt to ensure it properly fits inside the drilled Hole.

SECTION 7.5: Install the Bottom Guide

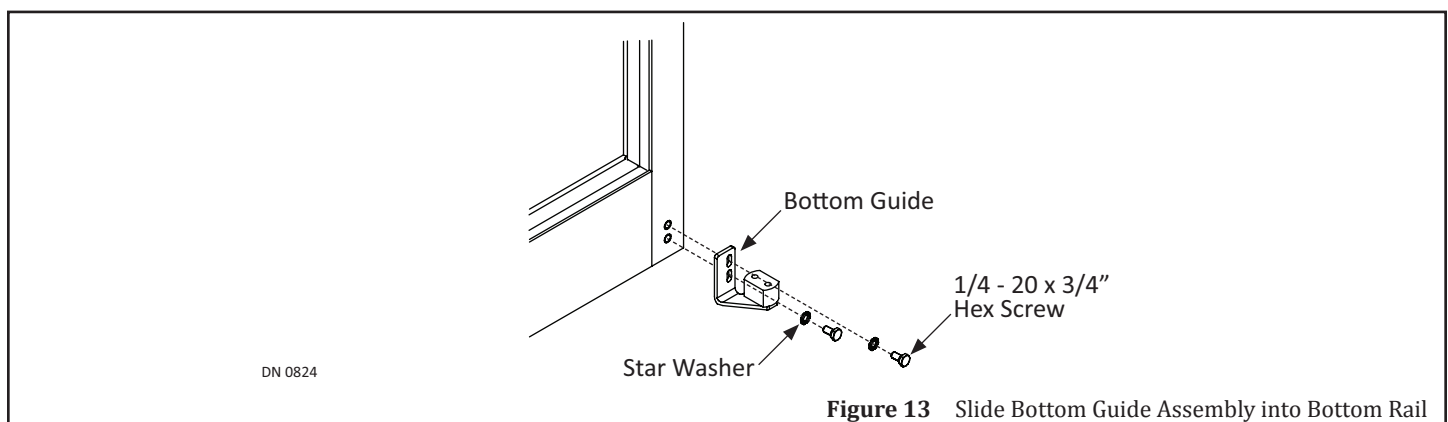
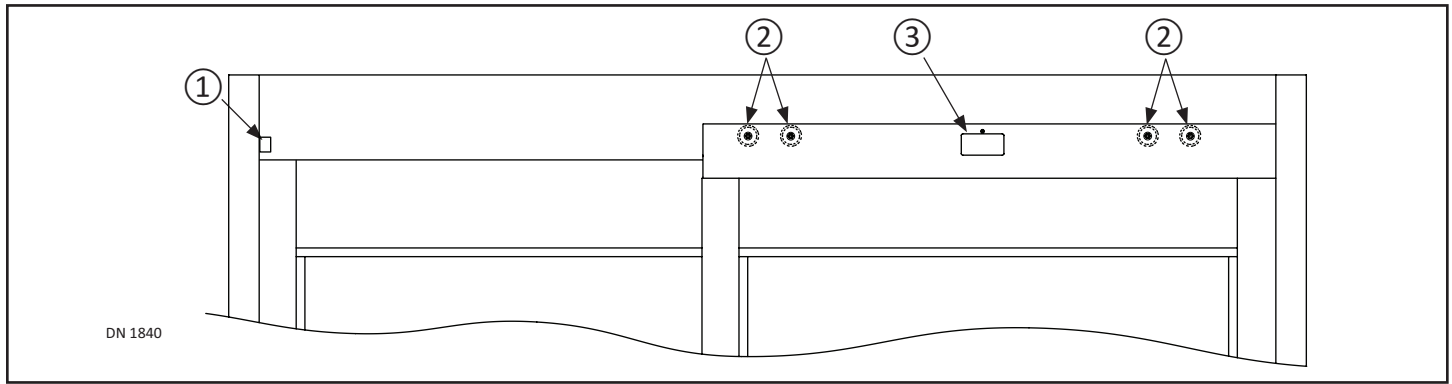

Figure 13 Slide Bottom Guide Assembly into Bottom Rail

1. Obtain (1) Bottom Guide, (2) 1/4" Star Washers, and (2) 1/4 - 20 x 3/4 inch Hex Head Cap screws.
2. Go to the Strike Stile on Sidelite Panel. Locate (2) pre-drilled screw holes at the bottom.
3. Slide (1) 1/4 inch Star Washer onto each 1/4 - 20 x 3/4 inch Hex Head Cap screw.
4. Position the Bottom Guide so it is flush with the bottom of the Sidelite.
5. With a 7/16 inch Box End Wrench, secure the Bottom Guide to the Sidelite Panel with 1/4 - 20 x 3/4 inch Hex Head Cap screws.

CHAPTER 8: INSTALL THE SLIDE DOOR



1. Door Stop 2. Hanger Roller 3. Instruction Label

SECTION 8.1: Lift Carrier onto Track

Attention: It is the responsibility of the Installer to reverse Hanger Roller location before installing the Slide Door.

1. Cover the Trail door with cardboard on the side that will face the Lead door.
2. Go to the front side of Carrier located on Top Rail of Slide door.
3. Remove each Hanger Roller by loosening the nut with a 1/2" open end Wrench. Go to the backside of Carrier. Reinstall each Hanger Roller by partially tightening each nut with a 1/2" open end Wrench.
 - a. Hanger Rollers must be loose for the Slide door to 'catch' onto the Track properly.
 - b. For detailed instruction, please refer to the Label located on the Face of Carrier.

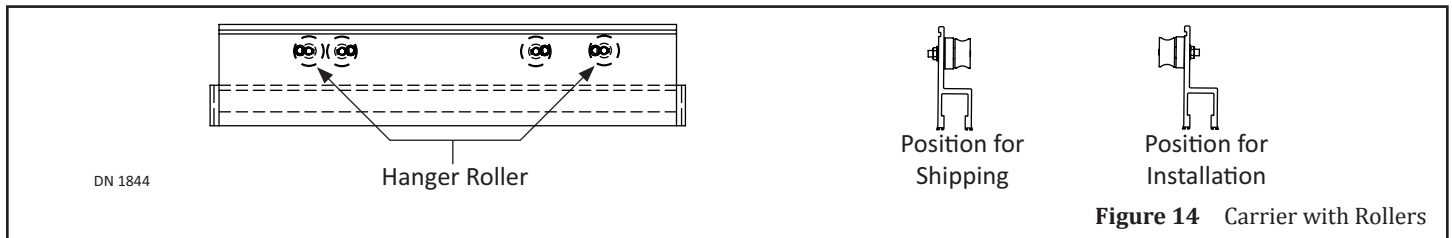

Figure 14 Carrier with Rollers

4. With Slide door tilted, install the Carrier onto the Track.
 - a. Slide door is slightly tilted to make it easier for the (4) Rollers to 'catch' onto the track.

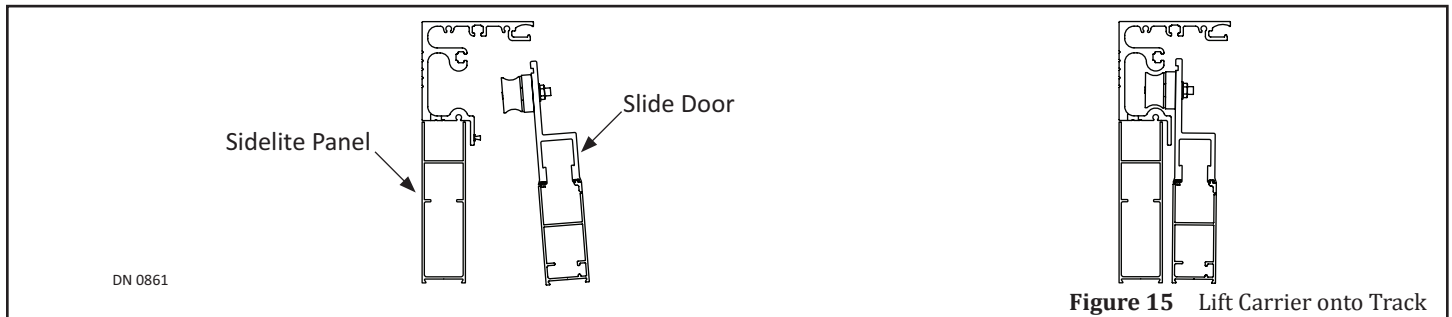

Figure 15 Lift Carrier onto Track

CHAPTER 9: INSTALL WEATHERING

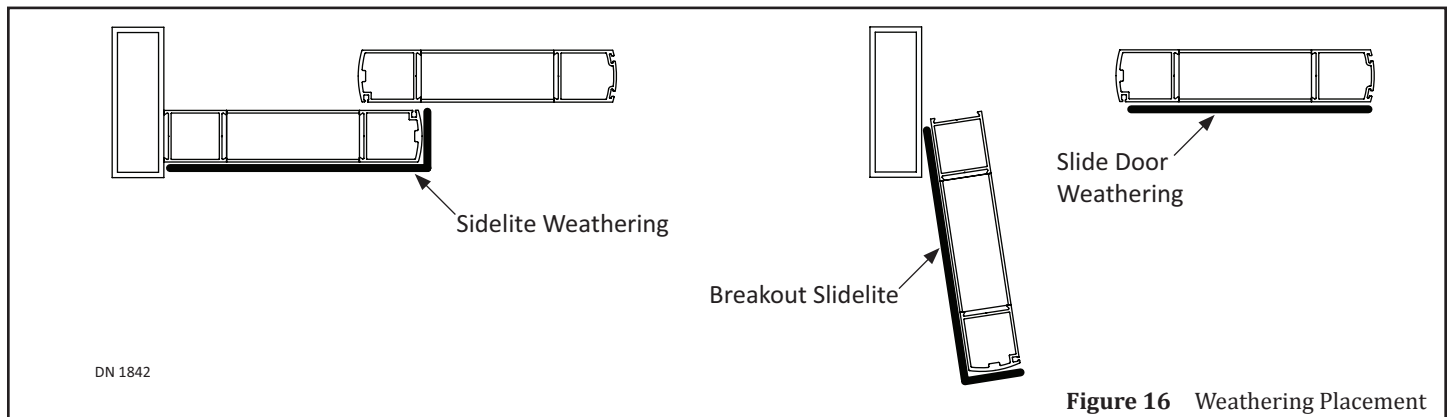

Figure 16 Weathering Placement

1. Slide Brush into the Brush Holder.
2. Secure the Brush Holder onto Bottom Rail of Swing Sidelite with (3) #6 x 1/2 inch self tapping screws.
 - a. It is recommended to leave at least a 1/8 inch gap between the Edge of the Pivot Stile and the Brush Holder, while allowing 1/8 inch Vinyl to extend past the Brush Holder so the gap is filled.
3. Breakout the Swing Sidelite. Secure the Brush Holder onto Bottom Rail of Slide door with (3) #6 x 1/2 inch self tapping screws.
4. Ensure the Door Frame is properly secured to the Rough Opening.
5. Apply caulking bead between the Door Frame and Rough Opening (inside and outside).
6. Apply caulking bead to the Threshold at the bottom of Door Frame.

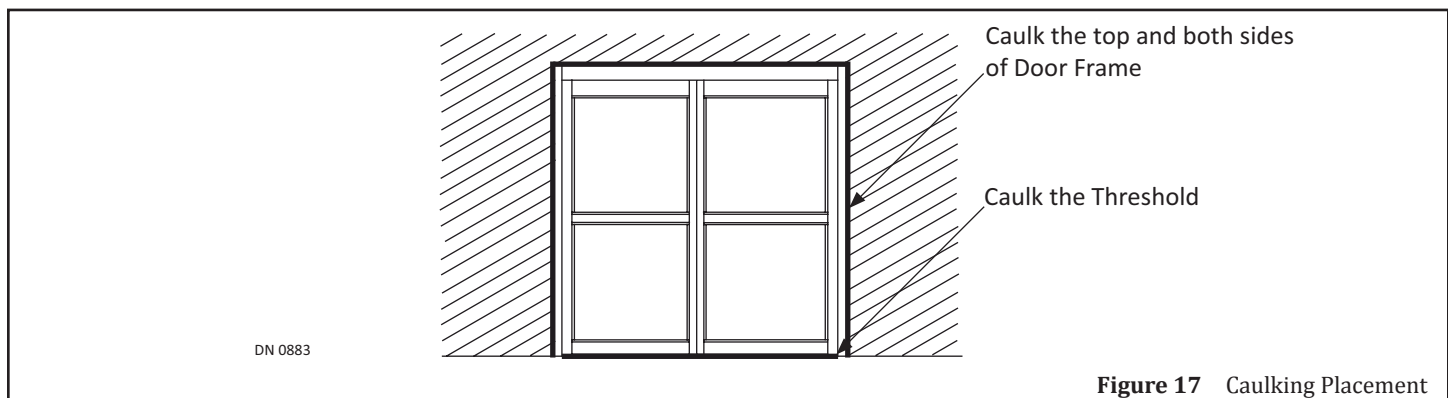

Figure 17 Caulking Placement

CHAPTER 10: INSTALL THE GLASS STOPS

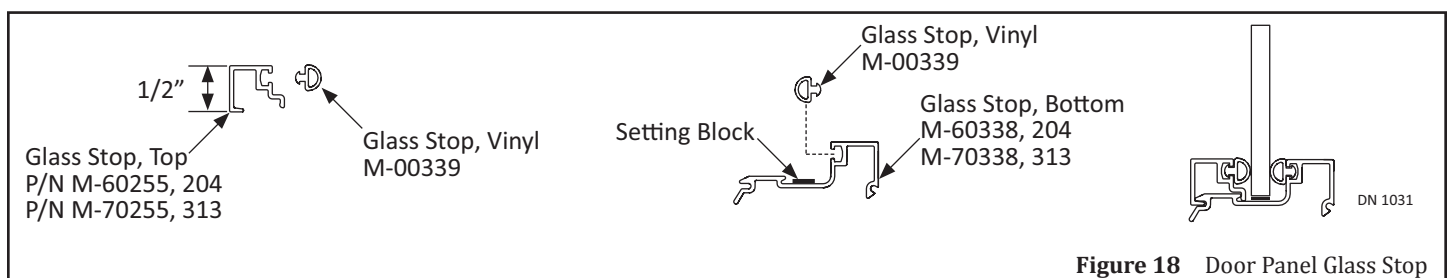

Figure 18 Door Panel Glass Stop

Note: The Snap Base and Vinyl Seals/Gaskets are preinstalled at the NABCO Factory.

1. Ensure the Snap Base is free of debris and/or sharp objects.
2. Install the Setting Blocks (not provided by NABCO) and Glass Panel.
3. Snap the Glass Stop into the Snap Base.

CHAPTER 11: GLAZING (HEAVY/WIDE DOORS)

Attention: Installation of all Glass must comply with ANSI Standard Z97.1

In accordance with standard glazing practices, Nabco recommends Cross-Blocking for maintaining square with heavy glass or wide Door Panels (Fixed and Full Open). Cross-Blocking helps direct glass weight away from the strike edge of the door, to prevent sagging and possibly dragging on the floor or threshold.

If the Door Panel is not square and sags at the lead edge, increase the thickness of the Glazing Block (not provided by NABCO). Increasing the thickness of the Glazing Block, raises the Door Panel.

Note: Only place Glazing Blocks in the designated marked spots.

1. Go to the STRIKE side of door panel at the TOP.
 1. Measure (6) inches from the Bottom edge of Top Rail, towards the Pivot side of Door Panel. Mark that spot.
 2. Measure (6) inches from the Top Corner of the Strike Edge down to the bottom of the Door Panel. Mark that spot.
3. Go to the PIVOT side of door panel at the BOTTOM.
 1. Measure (6) inches from the Top edge of Bottom Rail, up to the top of Door Panel. Mark that spot.
 2. Measure (6) inches from the Center of Pivot, towards the Strike side of Door Panel. Mark that spot.
3. Place (1) Glazing Block (not provided by NABCO) between the Glass and Door Frame, at marked spots.
 - a. It may be necessary to use more than (1) Glazing Block.

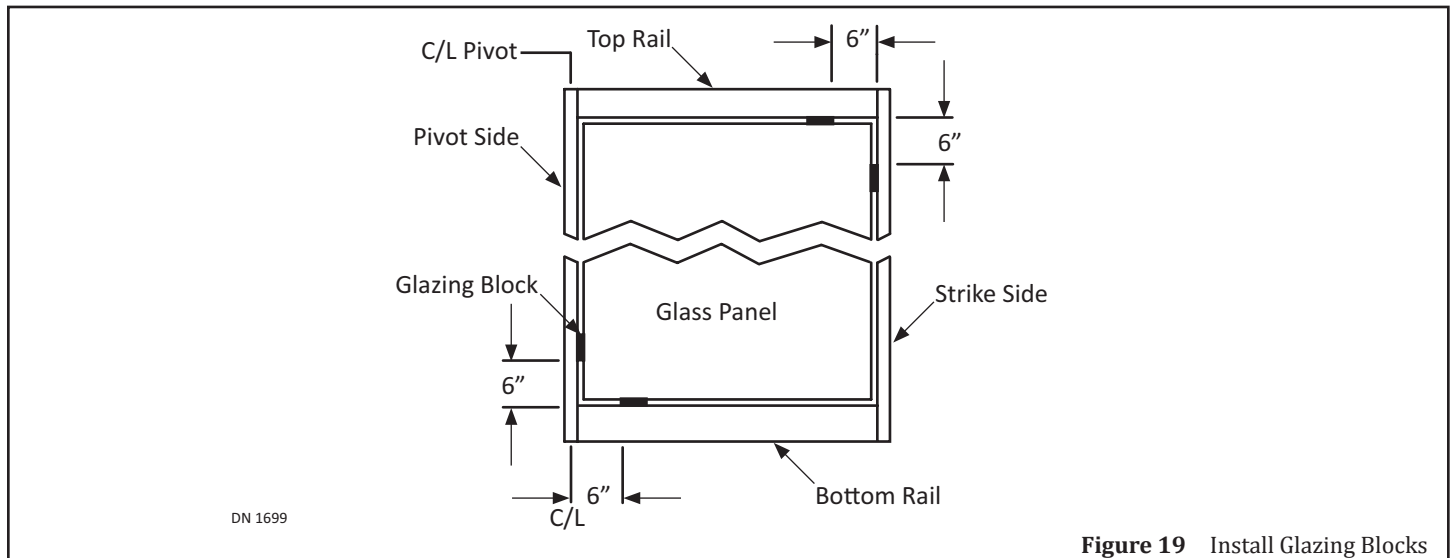

Figure 19 Install Glazing Blocks

CHAPTER 12: ADJUSTMENTS

SECTION 12.1: Adjust Height on Slide Door

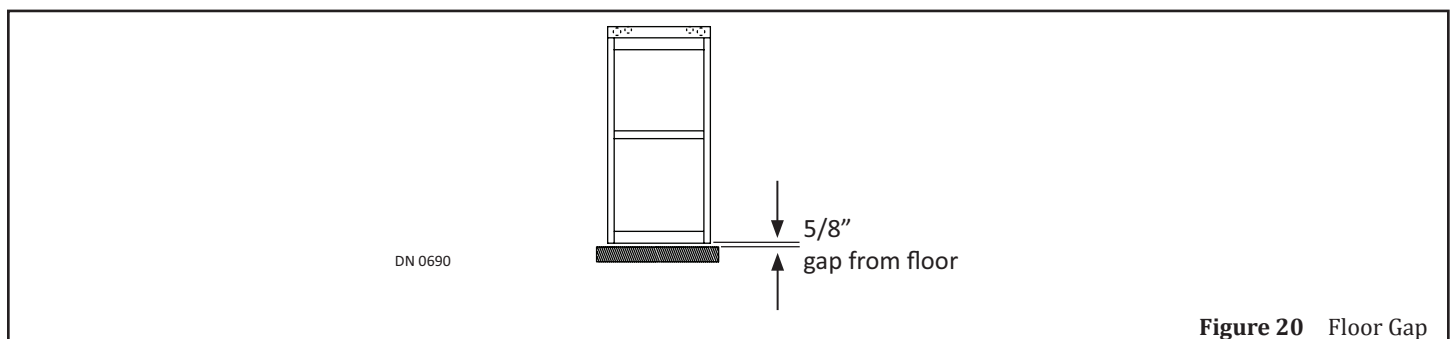

Figure 20 Floor Gap

The recommended gap between the Bottom Rail and the floor is 5/8 inch. Hanger Rollers are used to adjust the height of Slide door, and to ensure the Leading edge of Slide door and Sidelite Panel are parallel at the top or bottom.

CAUTION

Do not rotate the Roller Axle counter-clockwise. Doing so will unthread Axle from Hanger Roller.

1. Go to the Carrier on top of Slide Door. Loosen (4) Hanger Rollers by inserting (1) 7/32" Allen wrench into the exposed end of a Roller Axle. Hold the 7/32 inch Allen wrench in place to keep the Roller Axle stationary. At the same time, loosen (1) 7/16-20 Whiz Lock nut with a 15/16 inch Open End Wrench.

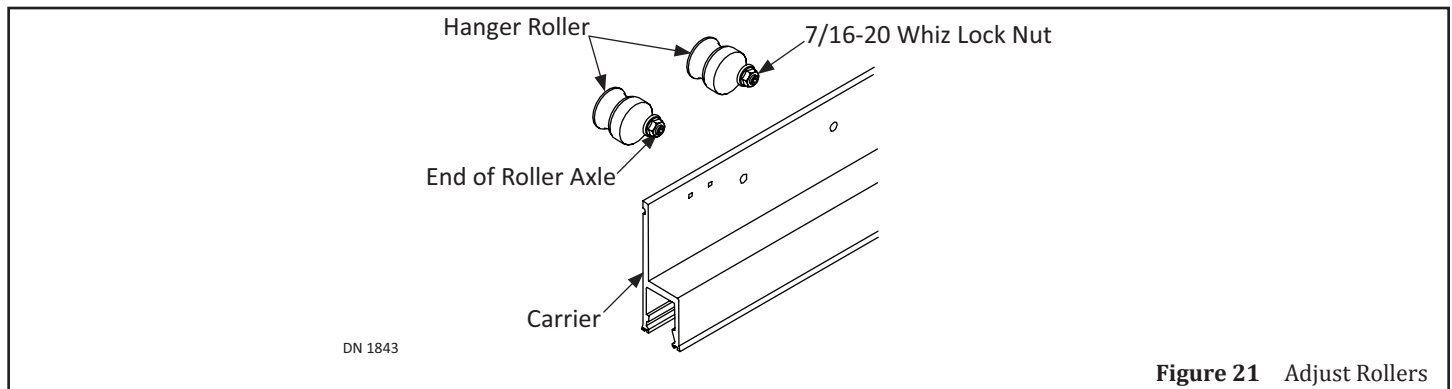

Figure 21 Adjust Rollers

2. Keep the Roller Axle stationary by clamping the 7/32 inch Allen wrench onto the exposed end of the Roller Axle.
3. Rotate the 7/16-20 Whiz Lock nut on each Hanger Roller to lower or raise the Slide Door.
4. Ensure the Leading Edge of the Slide door and Header are parallel.
5. With the 7/32 inch Allen wrench still in place, tighten each (1) 7/16-20 Whiz Lock nut with a 15/16 inch Open End Wrench.

SECTION 12.2: Adjust the Nose Caster

Note: Installed on Units that are 54 Inches Wide (or greater) and/or over 200 Pounds.

1. Go to the Bottom Rail. Remove (1) End Cap.
2. Breakout the Slide door. Locate the Nose Caster that was pre-installed within the Strike.

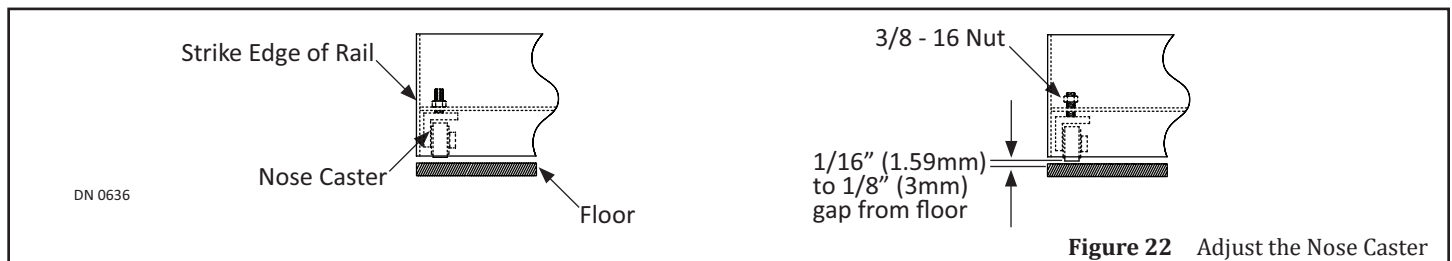
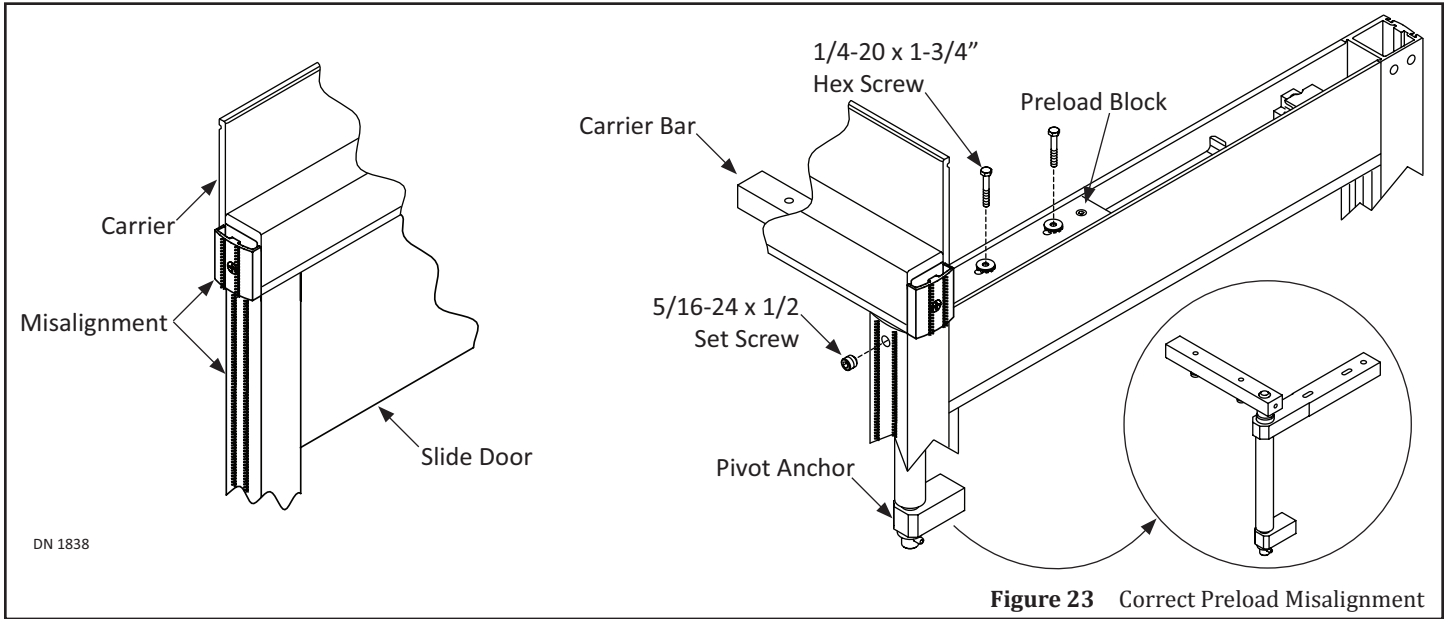

Figure 22 Adjust the Nose Caster

3. Loosen the #8-32 Set Screw. Position the Wheel so it is perpendicular to the Bottom Rail. Retighten the #8-32 Set Screw.
4. Fully close the Slide door. Ensure the Nose Caster does not hit or scrape the floor. Reinstall the End Cap. Correct Preload Misalignment.

SECTION 12.3: Correct Preload Misalignment

1. Breakout the Slide Door. Loosen the 5/16-24 x 1/2 Set Screw located on Pivot Stile, at the Top.
1. Go inside the Top Rail. Loosen (2) 1/4-20 x 1-3/4 inch Hex Screws used to secure the Preload Block to the Top Rail.
2. Slide the Pivot Carrier back or forth until the Slide Door and Carrier are properly aligned.
3. Fully close the Slide Door to ensure the Preload is aligned. Retighten the Hex Screws.



SERVICE PARTS: KIT

NARROW: RH P/N A-00614; LH P/N A-00615, Bi-Fold A-00616

MEDIUM: RH P/N A-00669; LH P/N A-00669, Bi-Fold A-00670

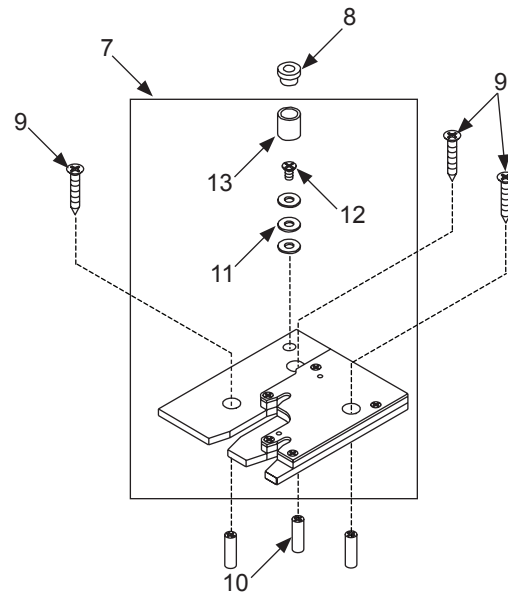
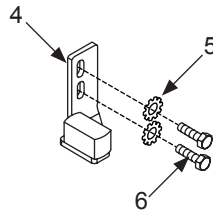
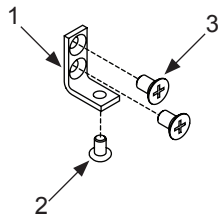

DN 1857

Service Parts Kit

Item	Part	Note	Description	QTY	Used To
1	M-01049		CLIP, COVER	2	Secure Cover to Header and Jamb Tube
2	T-00323		RHMS,8-32x0.250L.,PHIL,ZINC	2	Secure Cover to Header
3	T-00016		FHMS,1/4-20x0.438L.,PHIL,UNDERCUT,ZINC	4	Secure Cover to Jamb Tube
4	A-00318	LH,NAR	GUIDE BLOCK, NAR STILE, LH	2	Guide Slide Door back/forth, keep Rollers in Track
	A-00321	RH,NAR	GUIDE BLOCK, NARR STILE, RH		
	A-00325	LH,MED	GUIDE BLOCK, MED STILE, LH		
	A-00327	RH,MED	GUIDE BLOCK, MED STILE, RH		
5	T-00087		WASHER, LOCK, EXT, 1/4 ID, ZINC	4	Keep screws from moving up/down Screw Hole
6	T-00064		HHCS,1/4-20x0.750L.,ZINC	4	Secure Guide Block to Stile
7	A-00666	RH	PIVOT :2 PANEL TRACKLESS:RH	1	Swing Open Slide Door
	A-00667	LH	PIVOT :2 PANEL TRACKLESS:LH		
8	M-00606		BUSHING, BOTTOM PIVOT, SWING PANEL	1	Seat the Pivot Pin located inside Door Stile
9	T-00383		FHSMS:14 x1.500L.:PHIL: SS	3	Secure Pivot Assembly to floor
10	T-00314		SCREW ANCHOR, #16 X 1" LG	3	Anchor screws into floor
11	T-00084		WASHER,.313 ID,.734 OD,.065 THK,ZINC	3	Raise/Lower Door Height
12	T-00015		FHMS,1/4-20x0.750L.,PHIL,ZINC	1	Secure washers to Pivot Assembly
13	M-01107		PIVOT ,BOTTOM,SWING PANEL	1	House (1-3) Washers and Screw

SERVICE PARTS: HEADER

Viewed from **Non-Break Out Side**

* Sold in Parts Bag

P/N A-00614 Narrow RH

P/N A-00668 Medium RH

P/N A-00615 Narrow LH

P/N A-00669 Medium LH

P/N A-00616 Narrow BiPart

P/N A-00670 Medium BiPart

** BiPart Only

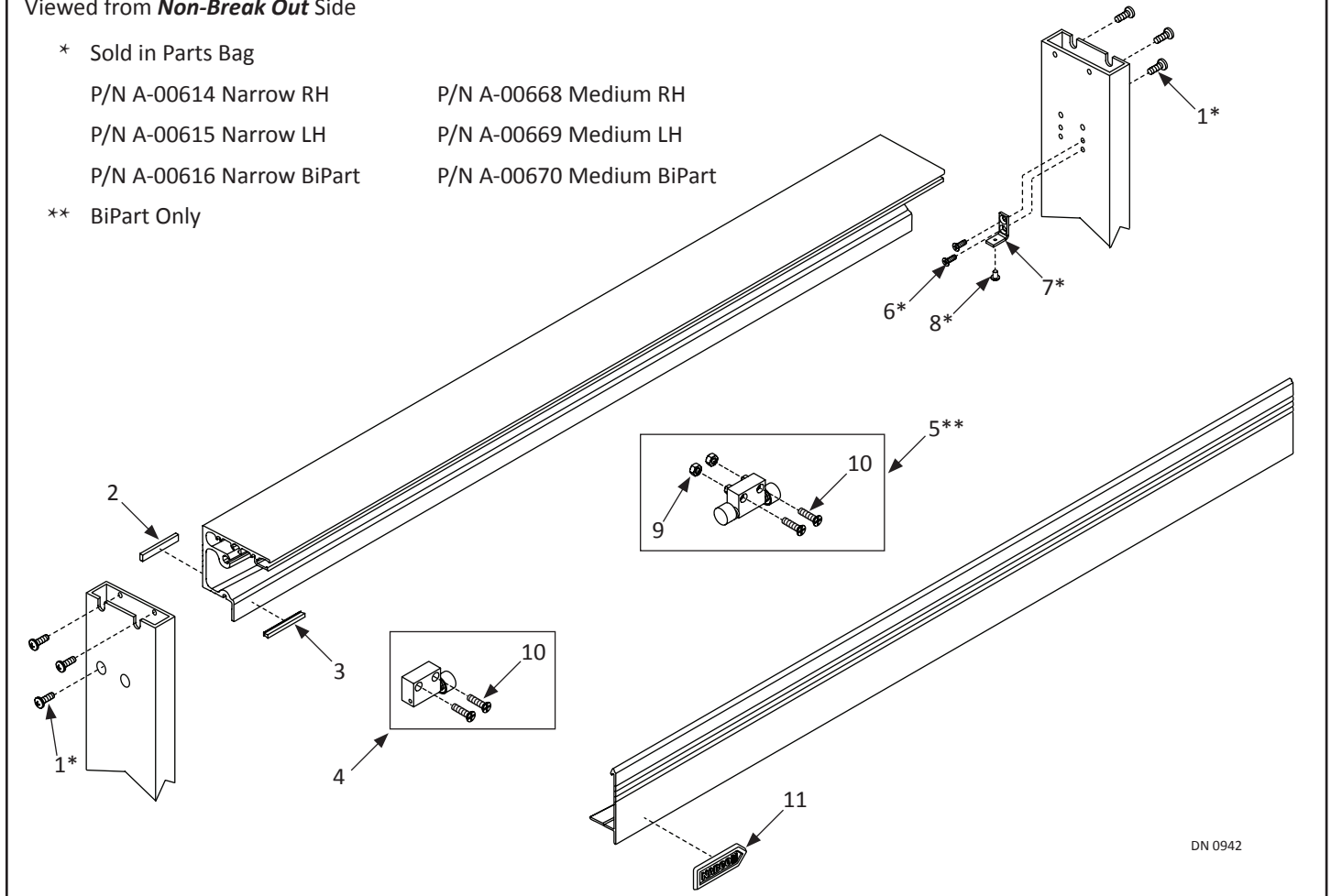

DN 0942

Header				
Item	Part	Finish/Sizes/Notes	Description	
1	T-00326		RHMS,1/4-20x0.750L.,PHIL,ZINC SELF TAPNG	
2	M-00281		FOAM WEATHERSTRIPPING ADHESIVE BACKED	
3	M-00688		PILE WEATHERING .45 TALL W/ ADHESIVE	
4	12-10714	RH	END STOP ASSEMBLY - RH	
	12-10829	LH	END STOP ASSEMBLY - LH	
5	12-11107	BiPart Only	DOOR STOP ASSEMBLY CENTER -BIPART	
6	T-00016		FHMS,1/4-20x0.438L.,PHIL,UNDERCUT,ZINC	
7	M-01049		CLIP, COVER	
8	T-00323		RHMS,8-32x0.250L.,PHIL,ZINC	
9	T-00002		NUT,HEX,1/4-20,ZINC	
10	T-00294		FHMS,1/4-20x1.000L.,PHIL,ZN	
11	C-00067		"NAMEPLATE, ADHESIVE BACKED"	

SERVICE PARTS: FULL OPEN SIDELITE

Viewed from *Non-Break Out* Side

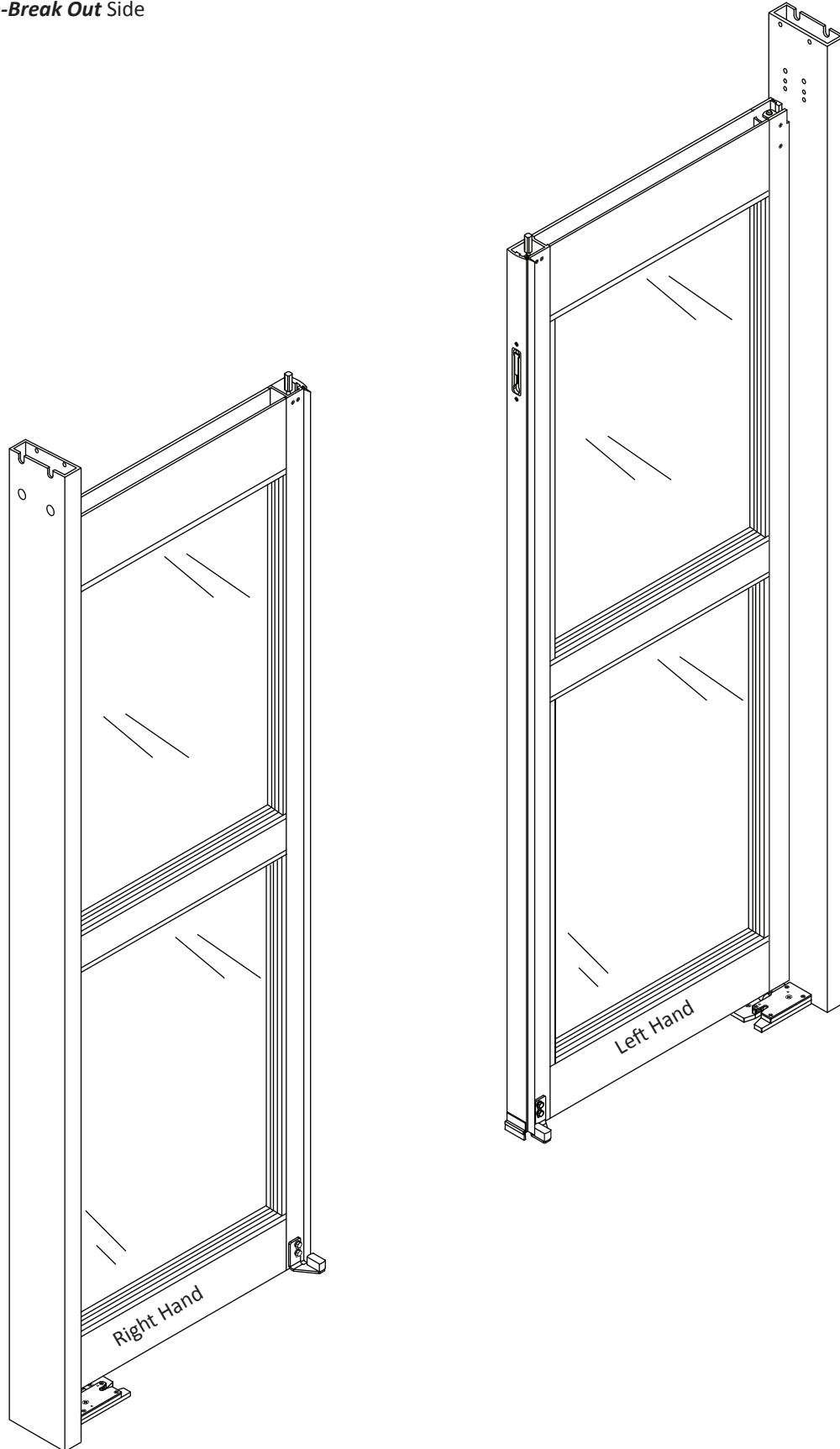

DN 0921

SERVICE PARTS: RIGHT HAND FULL OPEN SIDELITE

Viewed from **Non-Break Out** Side

* Sold in Parts Bag

P/N A-00614 Narrow RH

P/N A-00615 Narrow LH

P/N A-00616 Narrow BiPart

P/N A-00668 Medium RH

P/N A-00669 Medium LH

P/N A-00670 Medium BiPart

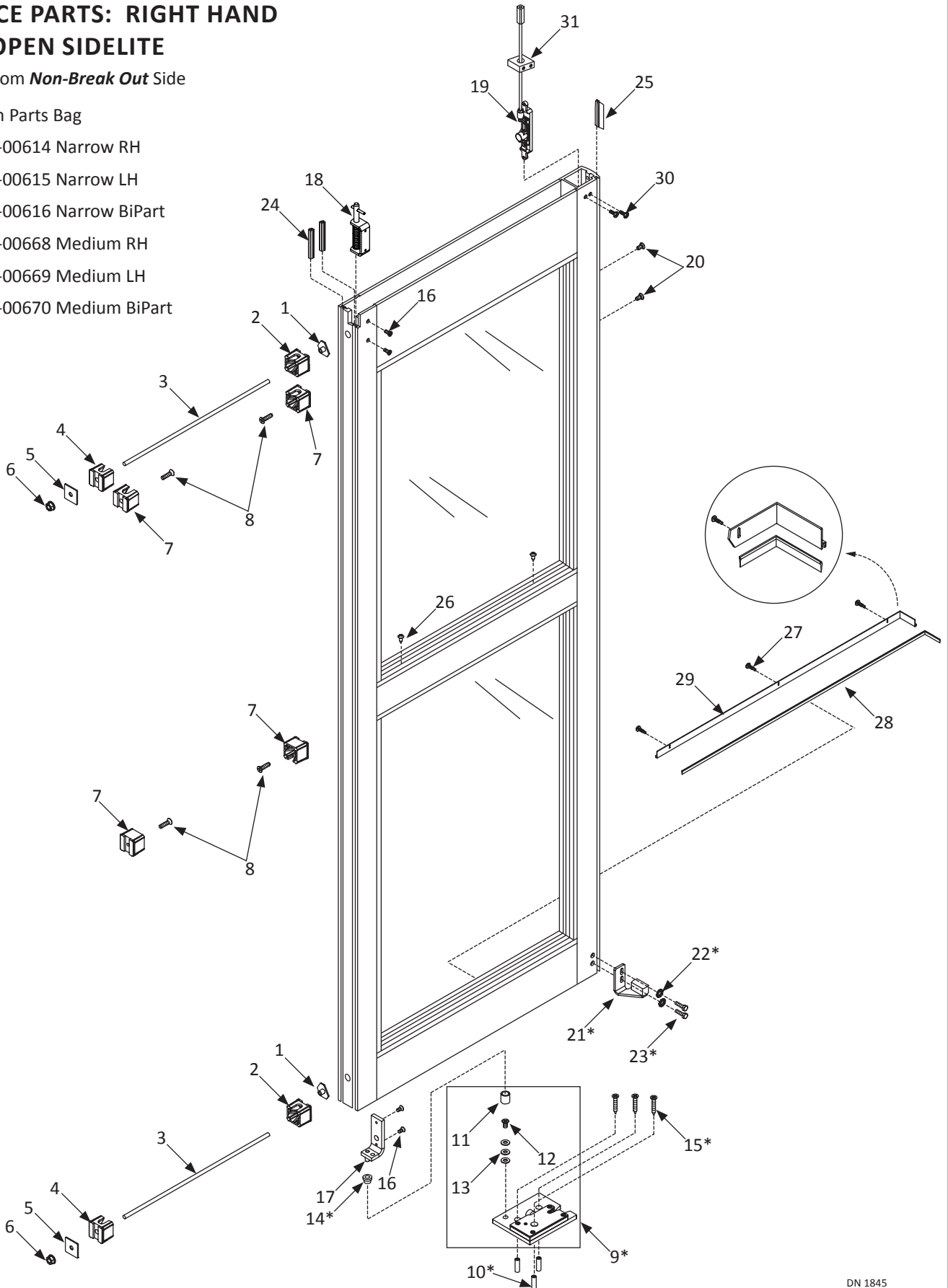

SERVICE PARTS: LEFT HAND FULL OPEN SIDELITE

Viewed from *Non-Break Out* Side

- * Sold in Parts Bag
- P/N A-00614 Narrow RH
- P/N A-00615 Narrow LH
- P/N A-00616 Narrow BiPart
- P/N A-00668 Medium RH
- P/N A-00669 Medium LH
- P/N A-00670 Medium BiPart

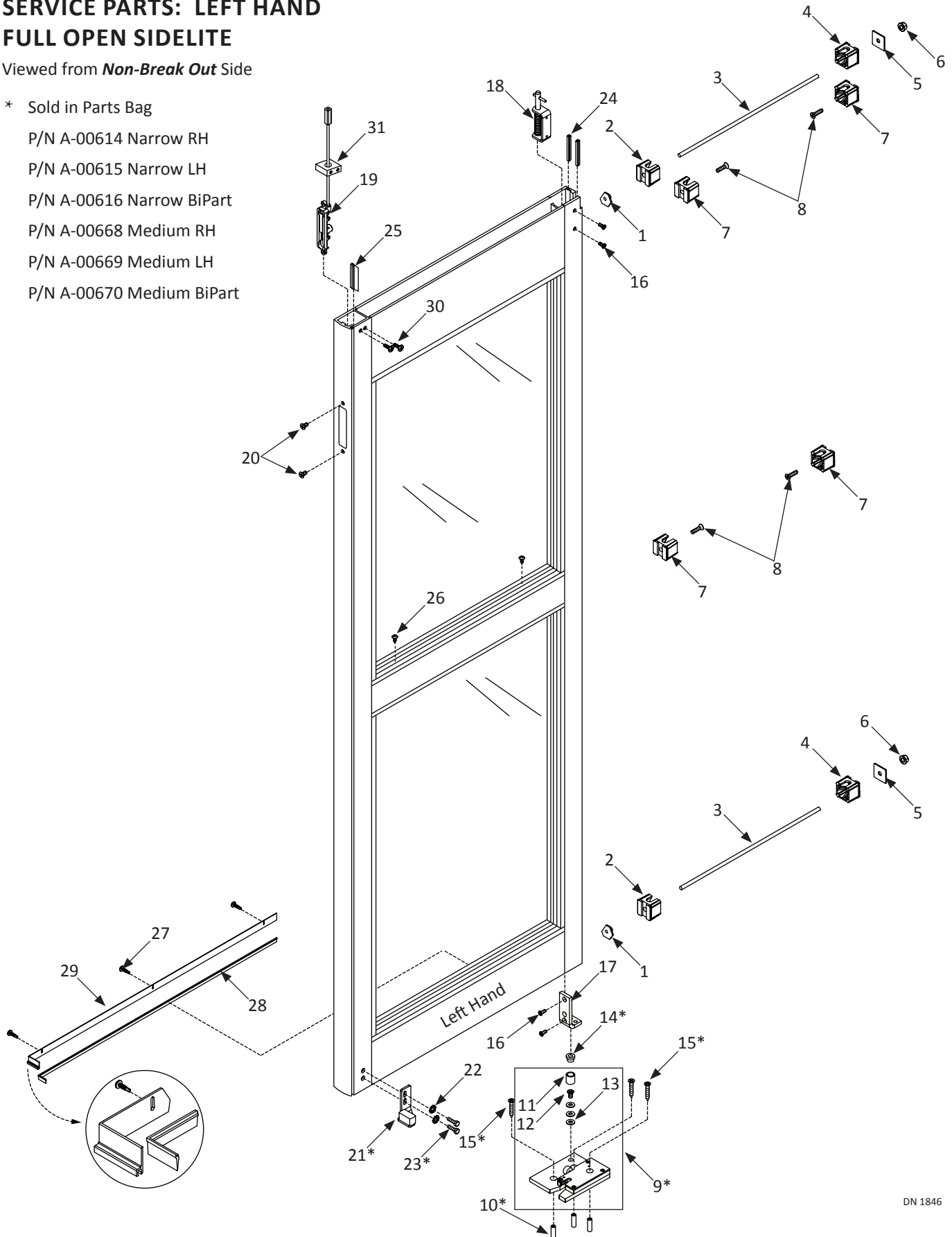

DN 1846

Full Open Sidelite			
Item	Part	Finish/Sizes/Notes	Description
1	M-00416		T-NUT, 3/8"-16, TIE ROD
2	M-00460	.500 Hole	CLIP,MUNTIN,.500 HOLE
3	M-00272	Zinc	3/8-16 THREADED ROD
4	M-00461	.386 Hole	CLIP,MUNTIN,.386 HOLE
5	M-00422		PLATE,TIE ROD
6	T-00025	Zinc	NUT,WHIZLOCK,3/8-16,ZINC
7	M-00462	.261 Hole	CLIP,MUNTIN,.261 HOLE
8	T-00061	Zinc	FHMS,1/4-20x1.000L.,PHIL,TRI-LOBE,ZINC
9	A-00666		PIVOT :2 PANEL TRACKLESS:RH
	A-00667		PIVOT :2 PANEL TRACKLESS:LH
10	T-00314		SCREW ANCHOR, #16 X 1" LG
11	M-01107		PIVOT ,BOTTOM,SWING PANEL
12	T-00015		FHMS,1/4-20x0.750L.,PHIL,ZINC
13	T-00084		WASHER,.313 ID,.734 OD,.065 THK,ZINC
14	M-00606		BUSHING, BOTTOM PIVOT, SWING PANEL
15	T-00383		FHSMS:14 x1.500L.:PHIL: SS
16	T-00184		FHMS,10-32x0.500L.,PHIL,UCUT,TRI-LOBE,ZN
17	M-00594	RH	PIVOT, SWING PANEL,BTM,RH
	M-00593	LH	LH BOTTOM PIVOT SWING PANEL
18	A-00029		ASM, TOP PIVOT, 1175 SWING PANEL
19	A-00332	Clear	FLUSH BOLT, W/ CUT,204
	A-00382	Dark Bronze	FLUSH BOLT, W/ CUT.313
20	T-00043		FHMS,10-24x0.375L.,PHIL,UNDERCUT,ZINC
21	A-00318	LH	GUIDE BLOCK, NAR STILE, LH
	A-00321	RH	GUIDE BLOCK, NARR STILE, RH
	A-00325	LH	GUIDE BLOCK, MED STILE, LH
	A-00327	RH	GUIDE BLOCK, MED STILE, RH
22	T-00087		WASHER, LOCK, EXT, 1/4 ID, ZINC
23	T-00139	Zinc	HHCS,1/4-20x1.000L.,GR5,ZINC
24	M-01244	Black	WEATHERING,BULB
25	M-01241	Smoke Seal Only/Gray	WEATHERING, VINYL, 9/16IN GRAY FIN
	M-71241	Smoke Seal Only/Black	WEATHERING,VINYL,9/16IN,BLK
26	T-00098		PHSMS,10x0.563L.,PHIL,TYPE A
27	T-00222	Smoke Seal Only/Zinc	PHSMS,6x0.500L.,PHIL,TEKS,ZINC
	T-00260	Smoke Seal Only/Black Zinc	PHSMS,6x0.500L. PHIL,TEKS BLK ZN
28	M-01239	Smoke Seal Only/Gray	WEATHERING, VINYL, 1IN GRAY FIN
29	14-10659-01	LH/Smoke Seal Only/Clear	WEATHERING HOLDER
	14-10659-02	LH/Smoke Seal Only/Dark Bronze	WEATHERING HOLDER
	14-10660-01	RH/Smoke Seal Only/Clear	WEATHERING HOLDER
	14-10660-02	RH/Smoke Seal Only/Dark Bronze	WEATHERING HOLDER
30	T-00182		PHMS,10-32x0.500L.,PHIL,F-POINT,ZINC
31	M-00100		BLOCK, 2100 GUIDE LOCK, ROD END

SERVICE PARTS: SLIDE DOOR

Viewed from *Non-Break Out* Side

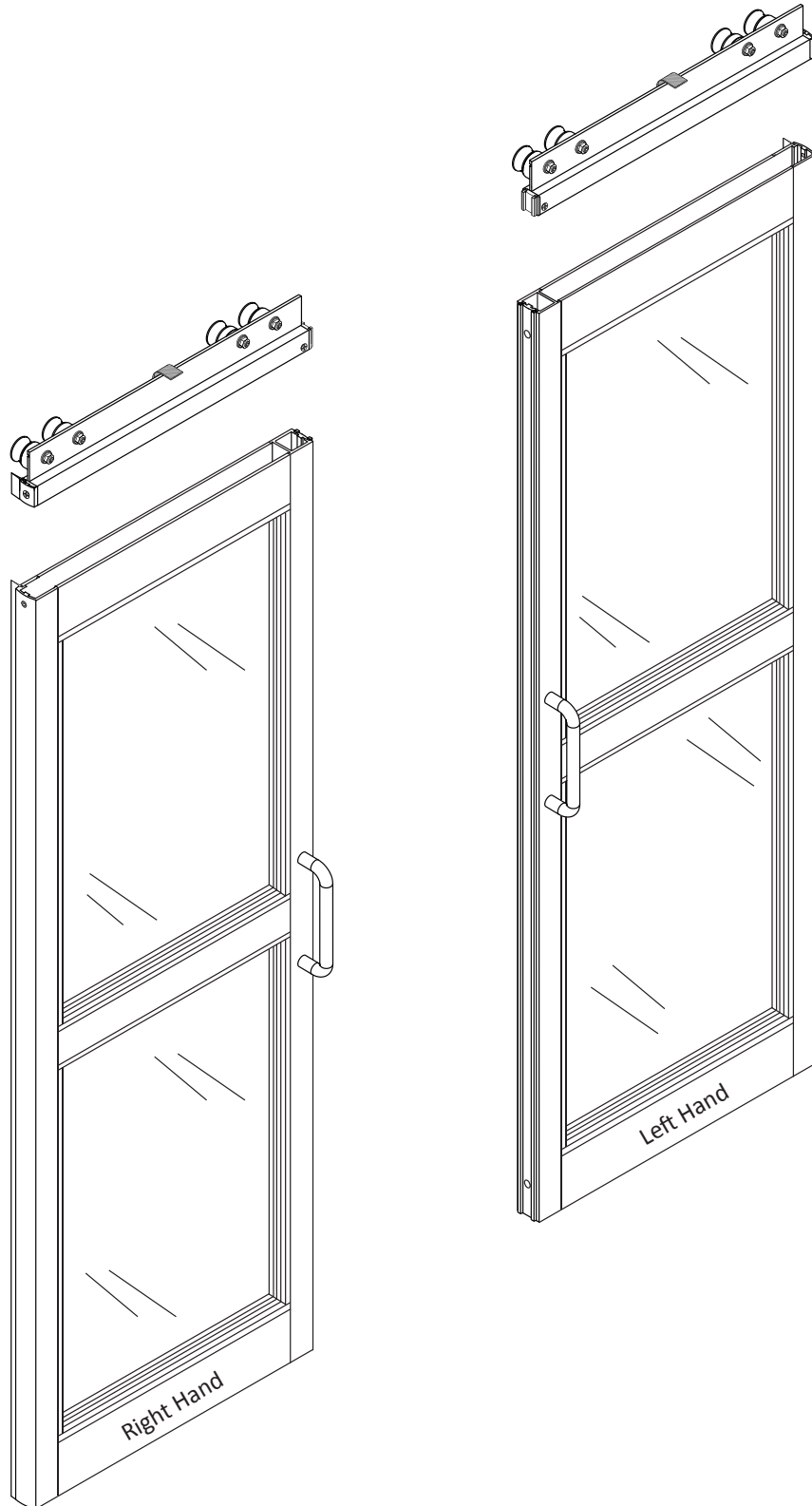

DN 0924

SERVICE PARTS: RIGHT HAND SLIDE DOOR

Viewed from *Non-Break Out* Side

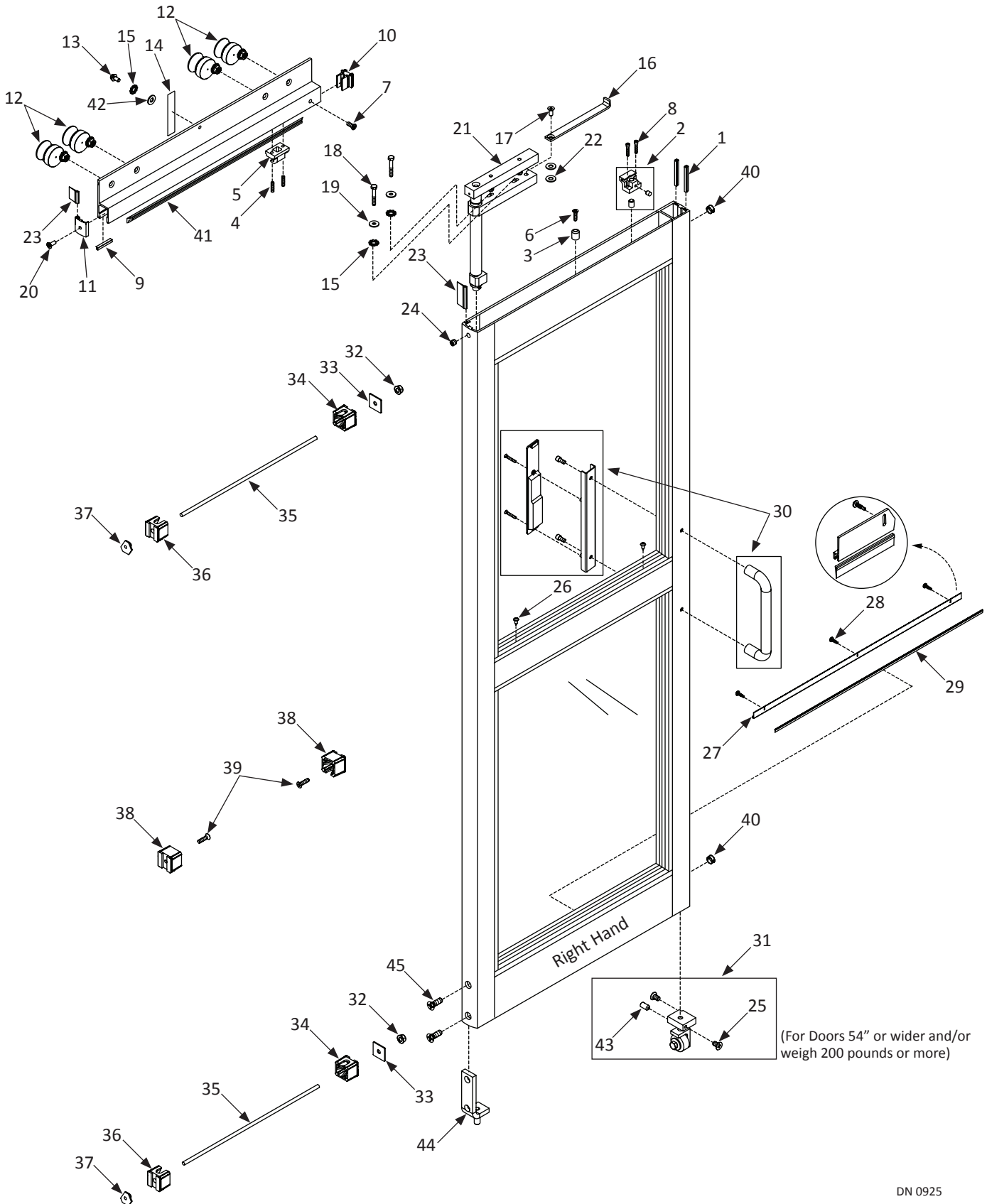

SERVICE PARTS: LEFT HAND SLIDE DOOR

Viewed from *Non-Break Out* Side

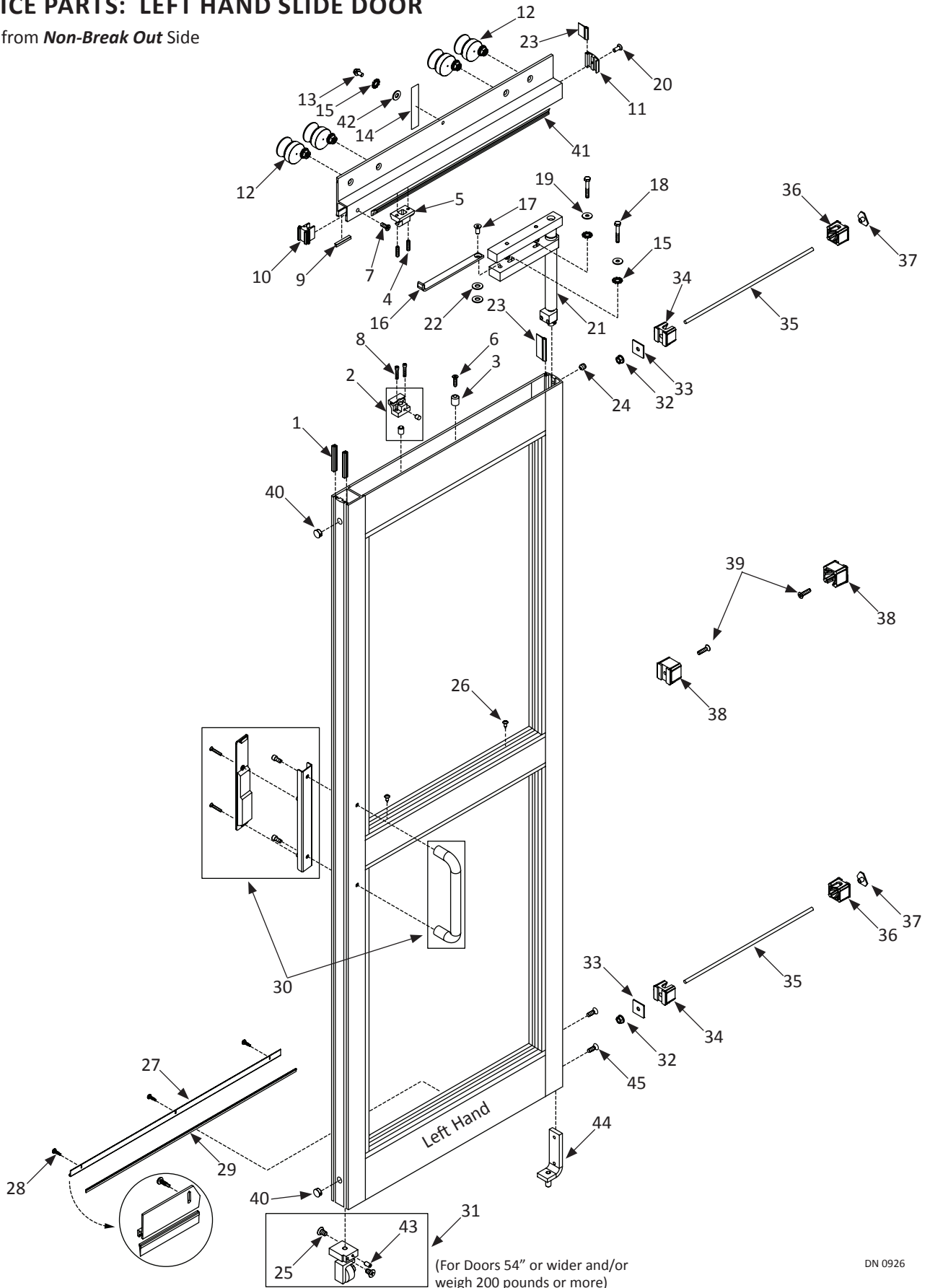

DN 0926

Slide Door			
Item	Part	Finish/Sizes/Notes	Description
1	M-01244	Black	WEATHERING,BULB
2	A-01128		PANIC CATCH,BOTTOM;MODEL1100;W-1/8WALL
3	M-00653		BRACKET, LIMIT ARM SUPPORT
4	T-00091		SHSS,5/16-18x1.250L.,CUP PT.
5	M-00483		PANIC CATCH RELEASE ASSEMBLY
6	T-00061	Zinc	FHMS,1/4-20x1.000L.,PHIL,TRI-LOBE,ZINC
7	T-00184	Zinc	FHMS,10-32x0.500L.,PHIL,UCUT,TRI-LOBE,ZN
8	T-00037		SHCS,1/4-20x1.250L.,ZINC
9	M-00690	Smoke Seal Only	WEATHER, PILE .2
10	A-00400	Clear	CARRIER END CAP,STRIKE SIDE,204
	A-00401	Dark Bronze	CARRIER END CAP,STRIKE SIDE,313
11	A-60940	Clear	"CARRIER,END CAP,MACHINED 204"
	A-70940	Dark Bronze	"CARRIER,END CAP,MACHINED 313"
12	A-00416		ROLLER HANGER,30mm
13	T-00346	Green	HHCS:1/4-20x0.375L:GREEN:WASH HD:SLOT
14	M-01275		STATIC ARRESTOR,STRIP 4"
15	T-00087		WASHER, LOCK, EXT, 1/4 ID, ZINC
16	M-00379		LIMIT ARM, STANDARD STILES
17	T-00018	Zinc	FHCS,7/16-14x1.000L.,ZINC
18	T-00028		HHCS,1/4-20x1.750L.,GR5,ZINC
19	T-00029		WASHER,.250 ID,.563 OD,.049 THK,ZINC
20	T-00183	Black Zinc	FHMS,10-32x0.500L.,PHIL,UCUT,23-PT,BLKZN
	T-00176	Zinc	FHMS,10-32x0.500L.,PHIL,UCUT,23-PT,ZINC
21	A-00092		CARRIER,PIVOT,NARROW STILE
	A-00165		CARRIER, PIVOT ASSY, MED STILE
	A-00168		CARRIER PIVOT ASM. NRW PANEL & STILE
	A-00172		CARRIER,PIVOT,ASM.,NRW.PNL - MED.STILE
22	T-00092		WASHER,.438 ID,1.00 OD,.083 THK,ZINC
23	M-01241	Smoke Seal Only/Gray	WEATHERING, VINYL, 9/16IN GRAY FIN
	M-71241	Smoke Seal Only/Black	WEATHERING,VINYL,9/16IN,BLK
24	T-00261	Black Oxide	SHSS,5/16-24x0.500L.,CUP PT.
25	T-00016	Zinc	FHMS,1/4-20x0.438L.,PHIL,UNDERCUT,ZINC
	T-00108	Black Oxide	FHMS,1/4-20x0.438L.,PHIL,UNDERCUT,BLK ZN
26	T-00098		PHSMS,10x0.563L.,PHIL,TYPE A
27	24-9125-01	Smoke Seal Only/Clear	WEATHERING EXT, 204
	24-9125-02	Smoke Seal Only/Dark Bronze	WEATHERING EXT, 313
28	T-00222	Smoke Seal Only/Zinc	PHSMS,6x0.500L.,PHIL,TEKS,ZINC
	T-00260	Smoke Seal Only/Black Zinc	PHSMS,6x0.500L. PHIL,TEKS BLK ZN
29	M-01239	Smoke Seal Only/Gray	WEATHERING, VINYL, 1IN GRAY FIN
	M-71239	Smoke Seal Only/Black	WEATHERING:VINYL:1.00:BLK
30	A-00988	Clear	HANDLE,D & RECESSED;KIT,204
	A-00989	Dark Bronze	HANDLE,D & RECESSED;KIT;313

Slide Door			
Item	Part	Finish/Sizes/Notes	Description
31	A-00198		NOSE CASTER ASSY, NAR
	A-00207		NOSE CASTER ASSY, MED
32	T-00025	Zinc	NUT,WHIZLOCK,3/8-16,ZINC
33	M-00422		PLATE,TIE ROD
34	M-00461		CLIP,MUNTIN,.386 HOLE
35	M-00272	Zinc	3/8-16 THREADED ROD
36	M-00460		CLIP,MUNTIN,.500 HOLE
37	M-00416		T-NUT, 3/8"-16, TIE ROD
38	M-00462		CLIP,MUNTIN,.261 HOLE
39	T-00061	Zinc	FHMS,1/4-20x1.000L.,PHIL,TRI-LOBE,ZINC
40	V-00720		PLUG,HOLE,13/16 DOME
41	24-9094-01	Clear	INTERFACE LEG - 204
	24-9094-02	Dark Bronze	INTERFACE LEG - 313
42	T-00054		WASHER,.281 ID,.625 OD,.065 THK,ZINC
43	T-00105		SHSS,8-32x0.313L.,CUP PT.
44	M-01414		PIVOT:BOTTOM:TELESCOPIC ICU
45	T-00017		FHMS,1/4-20x0.750L.,PHIL,BLK ZN